

Saramonic

Sound.Remarkable. 

Full-Duplex Wireless Intercom Headset System

全双工无线对讲耳机系统

WiTalk WT5D

User Manual
用户手册



Statement

Please read this manual carefully before use and operate and store in strict accordance with the instructions provided. Please retain for future reference.

For any issues that cannot be resolved with the user manual, please refer to your retailer for help or contact us at: info@saramonic.com.

Introduction

WiTalk WT5D is a full-duplex wireless intercom headset system that offers two-way communication at a range of up to 400m. It includes a Master headset and four Remote headsets, allowing up to 5 people to communicate simultaneously. Thanks to its hands-free design, WiTalk WT5D is ideal for applications where teams need full use of their hands, such as filmmaking, sports events, production crew communication, etc.

Packing List

Dual-Ear Master Headset×1
Dual-Ear Remote Headset×4
12V/2.5A DC Adapter×1
(CN, EU, USA Adapter Plugs included)
Ten-Port Charger×1
Rechargeable Battery×5

Dual-Ear Master Headset

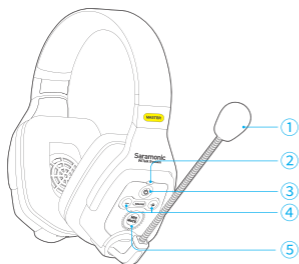

- ① Microphone
- ② Status indicator
- ③ Power button
- ④ Volume control (+/- button)
- ⑤ MIC/MUTE button

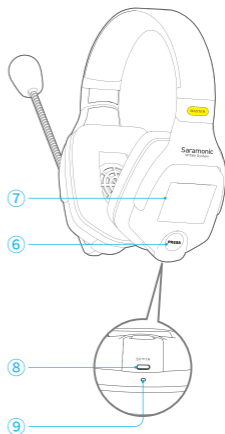

Dual-Ear Remote Headset

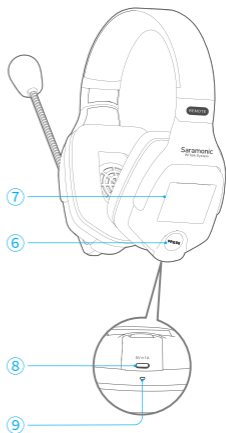
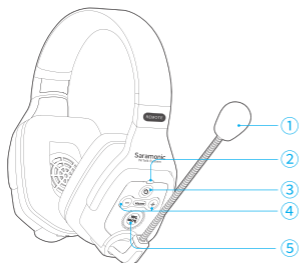

- ① Microphone
- ② Status indicator
- ③ Power button
- ④ Volume control (+/- button)
- ⑤ MIC/MUTE button
- ⑥ Release button
- ⑦ Battery compartment
- ⑧ USB-C charging port
- ⑨ Charging indicator

Ten-Port Charger

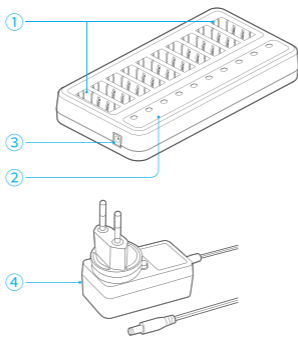

- ① Charging ports
- ② Charging indicators
- ③ DC jack
- ④ 12V/2.5A DC adapter

Operation Guide

How to Wear

1. Put on the headset and adjust to a comfortable size and position.

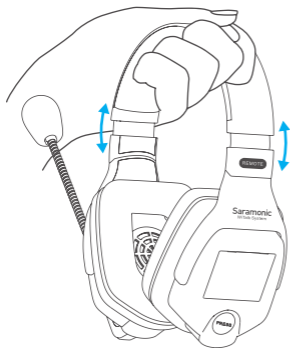

2. Adjust the boom and position the microphone capsule at about 2 cm in front of your mouth for optimum audio.

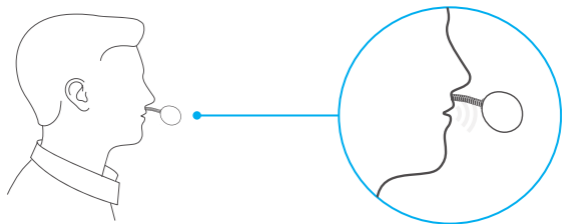

Power ON/OFF

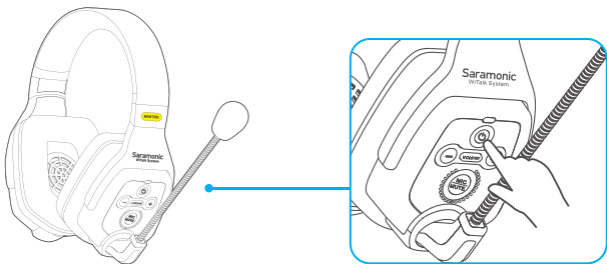

Press and hold the power button to turn on/off the Master/Remote headset.

Pairing

Before leaving factory, the WiTalk WT5D system is pre-paired. Therefore, the connection will be established once they are powered on. If they are disconnected, please follow below steps:

1. Make sure that the Master headset and four Remote headsets are powered off.
2. Press and hold the “+” button and the power button of Master headset simultaneously until indicator flashes blue rapidly. Then, press and hold the “+” button and the power button of Remote headset simultaneously to enter pairing mode.

Note: Each Master headset can have a maximum of 4 Remote headsets paired.

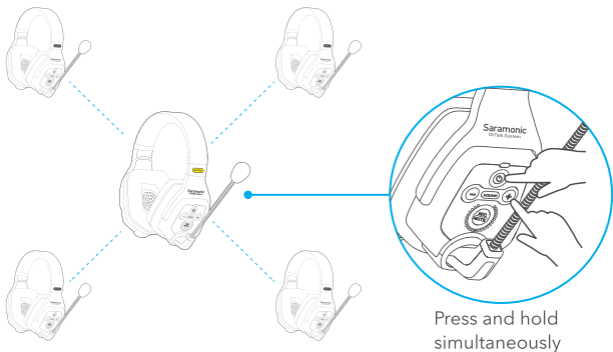

3. When indicators of Remote headsets turn slow flashing in blue light, press the power button of Master headset, the Master and the Remote headsets will be successfully paired within 10s, and all the indicators will turn solid blue.

Mode	Status indicator
Unpaired	Slowly flashing blue light
Pairing	Quickly flashing blue light
Paired Successfully	Solid blue light

Note:

1. When successfully paired with four Remote headsets, the indicator of Master headset will flash red, blue and purple, indicating that the maximum number of pairings has been reached.
2. After successfully paired with four Remote headsets, the Master headset cannot enter pairing mode by pressing power button and "+" button simultaneously. The indicator will blink red light. If you want to re-enable pairing mode, please clear the Master headset first.

Mute Function

Boom can swivel over the top 270 degrees. Thus, headset can be worn on both sides.

You can mute/unmute the microphone in the following two ways:

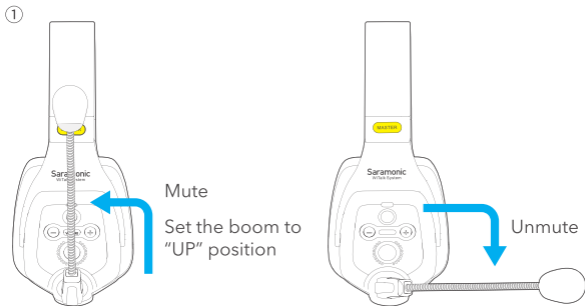

② Press the MIC/MUTE button to mute/unmute the microphone.

Mode	Status indicator
Mute ON	Flashing red light
Mute OFF	Solid blue light



Volume Control

Press the “-” button to decrease headphone volume.

Press the “+” button to increase headphone volume.

Clearing the Master Headset

When pairing with a repaired or replaced unit, the Master headset needs to be cleared before a Remote headset can be paired. Follow the steps below to clear the Master headset:

1. Make sure the Master headset is powered OFF.
2. Press and hold the power button and the “-” button until indicator flashes red and blue alternately. When the indicator turns off, the Master headset is cleared.

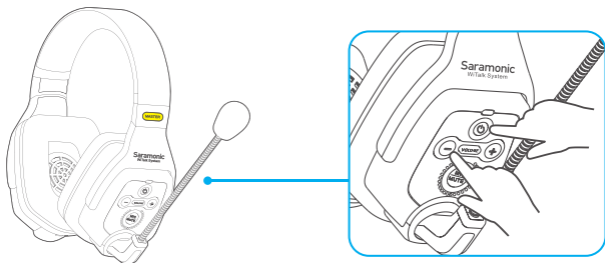

Battery Charging

Please recharge the device when battery is low.

Mode	Status indicator
Low Battery	Solid red light

1. Charge the battery via the charger.

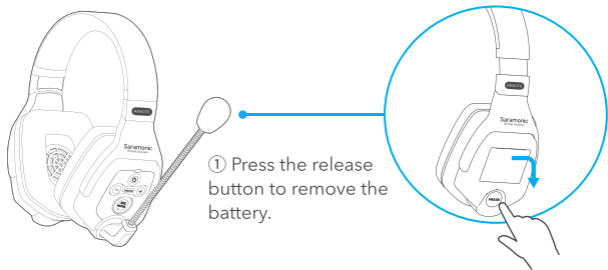

② Insert the battery and make sure the contacts are properly aligned.

Mode	Charging Indicator (Charger)
Charging	Solid red light
Fully Charged	Solid blue light

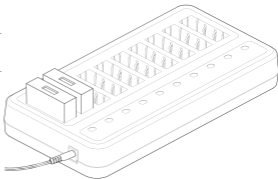

2. Charge the battery via a USB-C charging cable:

Mode	Charging Indicator (Headset)
Charging	Solid red light
Fully Charged	Solid blue light

Note: USB-C charging cable not included

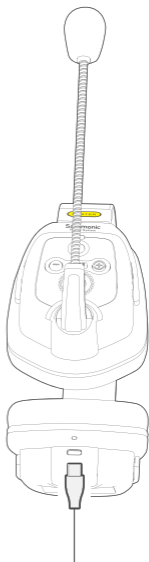

Specifications

Dual-Ear Master Headset

Duplex mode	Full-Duplex (FDX)
Modulation	GFSK
Carrier frequencies	1787MHz-1928MHz
Microphone type	Condenser microphone
Operating range	Up to 1312ft (400m) without obstacles
Frequency response	300Hz-5KHz
RF output power	<24dBm
Power consumption	<0.5W
SNR	65dB and more
Distortion	<1%
Power requirements	Li-ion Battery 3.7V/1200mAh or USB-C DC 5V
Battery life	Approx. 10 hours(with 2 Remotes), 5 hours(with 4 Remotes)
Weight	Approx. 360g(12.7oz)
Dimensions	175.1x203.1x85.8mm
Operating temperature	-10°C to 50°C
Storage temperature	-20°C to +55°C

Dual-Ear Remote Headset

Duplex mode	Full-Duplex (FDX)
Modulation	GFSK
Carrier frequencies	1787MHz-1928MHz
Microphone type	Condenser microphone
Operating range	Up to 1312ft (400m) without obstacles
Frequency response	300Hz-5KHz
RF output power	<24dBm
Power consumption	<0.5W
SNR	65dB and more
Distortion	<1%
Power requirements	Li-ion Battery 3.7V/1200mAh or USB-C DC 5V
Battery life	Approx. 18 hours
Weight	Approx. 360g(12.7oz)
Dimensions	175.1x203.1x85.8mm
Operating temperature	-10°C to 50°C
Storage temperature	-20°C to +55°C

声明

请在使用前仔细阅读本手册，并严格按照说明进行操作和存储。请保存以供将来参考。如果用户手册不能帮助您解决某些问题，请向零售商寻求帮助或给我们发送电子邮件：info@saramonic.com。

概述

WiTalk WT5D 是一款全双工无线对讲耳机系统，无线传输距离高达 400 米。套装内包含一个主机和四个从机，可实现 5 人同时进行对讲通信。产品使用时无需一直进行按钮操作，真正的做到解放双手，想说就说。WiTalk WT5D 非常适用于电影拍摄、跑马场、赛车场以及其他各种赛事现场等。

包装清单

双耳主机 × 1
双耳从机 × 4
12V/2.5A DC 适配器 × 1
(标配欧规、美规、中国大陆插头)
十槽充电座 × 1
锂电池 × 5

产品结构

双耳主机

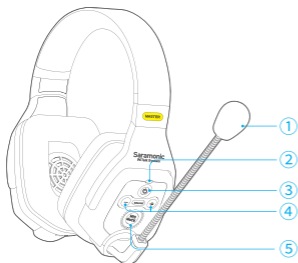

- ① 麦克风
- ② 状态指示灯
- ③ 电源键
- ④ 音量 +/- 键
- ⑤ 静音键

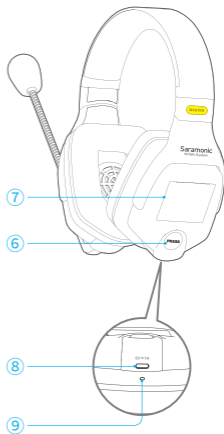

- ⑥ 电池释放键
- ⑦ 电池仓
- ⑧ USB-C 充电接口
- ⑨ 充电指示灯

双耳从机

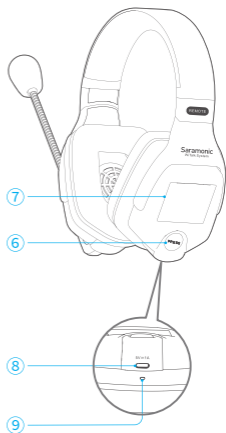
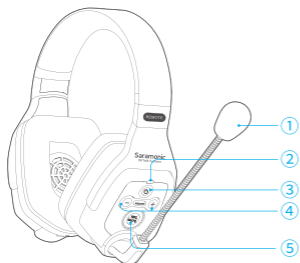

- ① 麦克风
- ② 状态指示灯
- ③ 电源键
- ④ 音量 +/- 键
- ⑤ 静音键
- ⑥ 电池释放键
- ⑦ 电池仓
- ⑧ USB-C 充电接口
- ⑨ 充电指示灯

十槽充电座

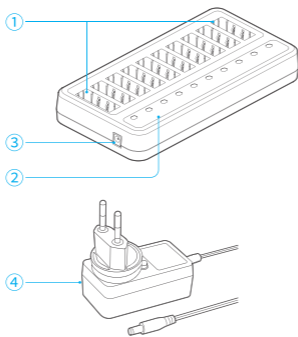

- ① 电池充电槽
- ② 充电指示灯
- ③ DC 插孔
- ④ 12V/2.5A DC 适配器

耳机佩戴

1. 戴上耳机，如图所示调整至舒适位置。

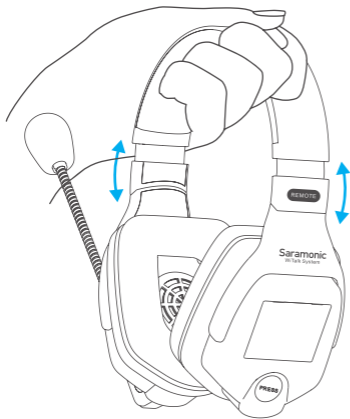

2. 调整麦克风角度，并将咪头置于嘴前约 2cm 处，以获得最佳音频效果。

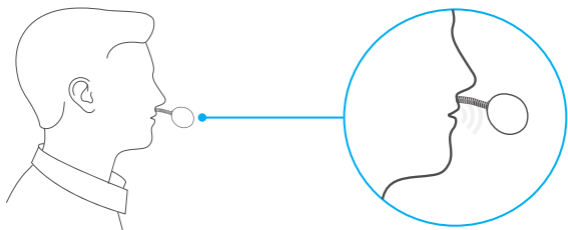

开 / 关机

长按电源键开启 / 关闭主机 / 从机

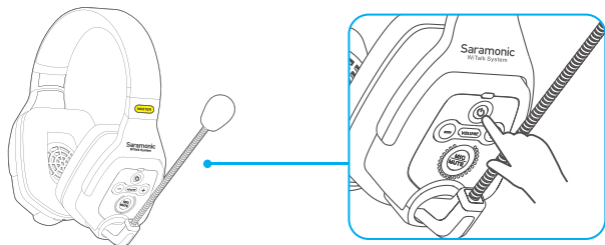

配对

WiTalk WT5D 套装出厂前已配对成功。因此，产品开机之后会自动联机。
若无成功连接，请进行如下配对操作：

1. 确保主机和从机处于关机状态。
2. 同时长按主机“+”键和电源键，待主机指示灯呈蓝灯快闪，然后同时长按从机“+”键和电源键，进入对码状态。

注意：请根据实际从机使用数量，进行对码操作，最多可同时连接四台从机。

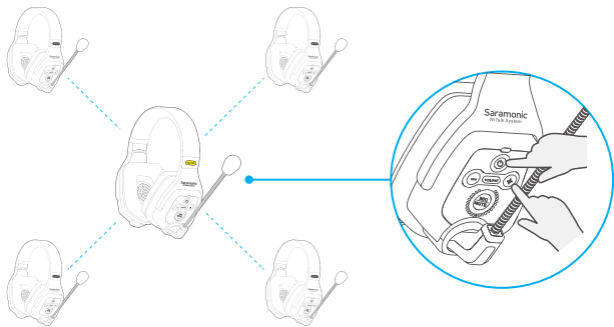

3. 当从机指示灯由蓝灯快闪变为慢闪时，短按主机电源键，主机和从机会在 10 秒内配对成功，指示灯变为蓝灯长亮。

模式	状态指示灯
未联机	蓝灯慢闪
对码中	蓝灯快闪
联机成功	蓝灯常亮

注意：

1. 主机一拖四联机成功后，指示灯会闪烁红蓝紫灯，提示已达到最大配对数量。
2. 主机一拖四联机成功后，在未清码状态下，主机长按电源键、“+”键也无法进入对码状态，指示灯呈红灯闪烁后转为蓝灯慢闪。

静音功能

麦克风动臂可旋转 270°，因此，耳机两侧均可佩戴。

可通过以下两种方式进入 / 退出静音模式：



②. 短按静音键进入静音模式 / 取消静音



模式	状态指示灯
静音开启	红灯闪烁
静音关闭	蓝灯常亮

音量控制

短按“-”键，减小音量；

短按“+”键，增加音量。

主机清码功能

在设备进行重新配对前，请先对主机进行清码操作，步骤如下：

1. 确保主机已关机。

2. 同时长按主机“-”键和电源键，待主机指示灯呈红蓝灯交替闪烁，此时主机正在清码（清除对码），之后主机指示灯会熄灭，此时清码操作完成。

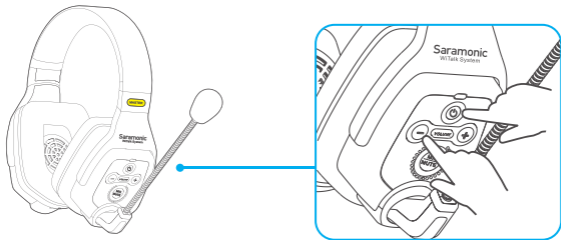

电池充电

若电池进入低电量状态，请及时进行充电：

模式	状态指示灯
低电量	红灯常亮

1. 使用充电座给电池充电

① 按下电池释放键，取出电池。

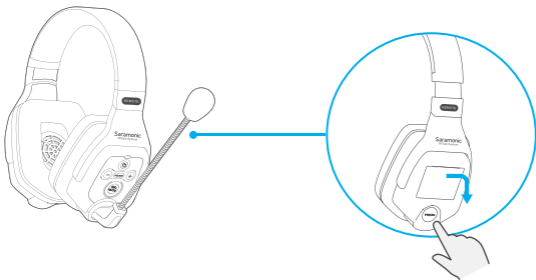

② 根据触点位置，将电池插入充电槽。

模式	充电座充电指示灯
充电中	红灯常亮
充满电	蓝灯常亮

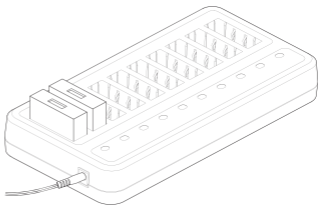

2. 使用 USB-C 充电线给电池充电。

模式	耳机充电指示灯
充电中	红灯常亮
充满电	蓝灯常亮

备注：USB-C 充电线不标配

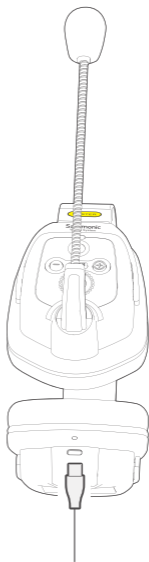

参数

双耳主机

双工模式	全双工模式
调制方式	高斯频移键控
载波频率	1787MHz-1928MHz
麦克风类型	电容式麦克风
操作距离	高达 400 米（无障碍）
频响范围	300Hz-5KHz
射频输出功率	<24dBm
功耗	<0.5W
信噪比	≥ 65dB
失真	<1%
供电方式	3.7V/1200mAh 锂电池或 USB-C 直流电 5V
续航时间	约 10 小时（一拖二） 约 5 小时（一拖四）
重量	约 360g
尺寸	175.1x203.1x85.8mm
工作温度	-10°C ~ 50°C
贮存温度	-20°C ~ +55°C

双耳从机

双工模式	全双工模式
调制方式	高斯频移键控
载波频率	1787MHz-1928MHz
麦克风类型	电容式麦克风
操作距离	高达 400 米（无障碍）
频响范围	300Hz-5KHz
射频输出功率	<24dBm
功耗	<0.5W
信噪比	≥ 65dB
失真	<1%
供电方式	3.7V/1200mAh 锂电池或 USB-C 直流电 5V
续航时间	约 18 小时
重量	约 360g
尺寸	175.1x203.1x85.8mm
工作温度	-10°C ~ 50°C
贮存温度	-20°C ~ +55°C



Scan the QR code and follow us!
扫描微信关注枫笛公众号

Shenzhen Jiayz Photo Industrial., Ltd
深圳市长丰影像器材有限公司

A16 Building, Intelligent Terminal Industrial Park of Silicon Valley
Power, Guanlan, Longhua District, Shenzhen, China
深圳市龙华区观澜街道大富工业区硅谷动力智能终端产业园 A16 栋

☎ 400-613-1096

🌐 www.saramonic.com

✉ info@saramonic.com

受控文件
2021-8-3
长丰影像

JIAYZ 长丰 深圳市长丰影像器材有限公司					
产品/零件名称	WITak WTSD 滤网布	比例	1:1	版本	V01
工程图号	WITak WTSD 滤网布	物料描述	100g 超细粒过筛 磨砂灯 亚克力滤网 P32		
物料编号	1F0306400161	尺寸/用量	120x50mm 1pcs		
公差/半公差/制程	是	正负公差			
制图人/日期	蔡航 2021.7.30				

修改名称	版本	变更内容	变更日期	变更担当
	V00	首次发行	2021.7.30	蔡航